

1.3.6 Energy Sensors Accessories

1.3.6.1 Accessories for Pyroelectric Sensors

**Fiberoptic Adapter for
Pyroelectric Sensors**



**Oscilloscope Adapter for
Pyroelectric Sensors**



**Heat Sink for
PE-C Series Sensors**



Beam Splitter Assembly

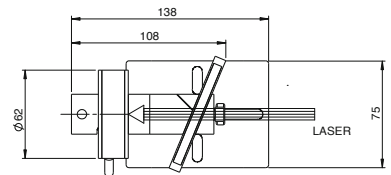
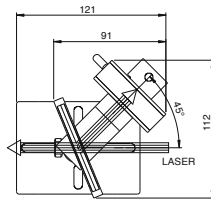

Beam splitter installed – reflected beam on sensor

Beam Splitter removed – direct beam on sensor

Beam Splitter Specifications

Material	UV grade fused silica	
Spectral range	0.19 - 2.2 μ m	
Aperture	ϕ 60mm	
Damage threshold for pulses	< 10ns PW	>300 μ s PW
	5J/cm ²	>200J/cm ²
Fraction split off	See graph	

F.S. Beam Splitter, 2 sided reflection unpolarized light

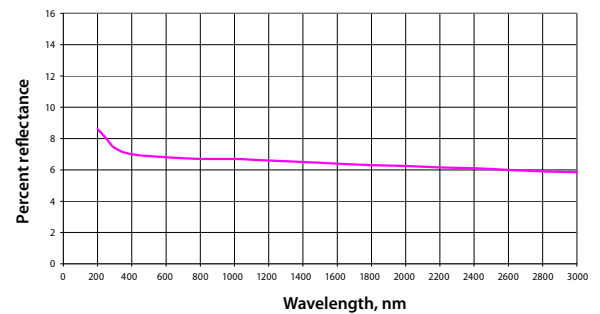

Accessory	Description	Part number			
Heat Sink	Heat sink that screws onto rear of PE25 and PE50 series sensors and allows working at over 50% higher average powers.	7Z08267			
Scope Adapter	Plugs in between the PE sensor and power meter. Provides BNC output to scope to see every pulse up to the maximum frequency of the sensor.	1Z11012			
Fiber Adapters	To mount fibers to sensors you need an adapter bracket and fiber adapter. All fiber adapters are compatible with the adapter bracket selected.				
Fiber Adapter Brackets	Mounting brackets to allow mounting fiber adapters to pyroelectric sensors.				
PE Sensor Family Type		Bracket P/N		Distance from fiber detector	
PD10-C / PD10-pJ-C / PD10-IR-pJ-C		7Z08275		10mm	
PE50-C / PE50BF-C		7Z08270		15mm	
PE9-C / PE10-C / PE10BF-C / PE25-C / PE25BF-C		7Z08269		10mm	
Fiber Adapters	Fiber adapters for mounting to above brackets	SC type	ST type	FC type	SMA type
For all PE sensors above		7Z08227	7Z08226	7Z08229	1G01236
Beam Splitter Assembly	Beam Splitter Assembly to measure pulsed laser sources too energetic for direct measurement. The reading with the Beam Splitter can be calibrated by setting the laser to a lower energy that will not damage the sensor and then taking a measurement with the beam splitter and without and taking the ratio.	7Z17001			

1.3.6.1 Accessories for Pyroelectric Sensors - Continued

Nova PE-C Adapter



Shock Absorbing
Mounting Post



Damage Threshold
Test Slides



IR Phosphor Glass



PE-C to PE Size Adapter

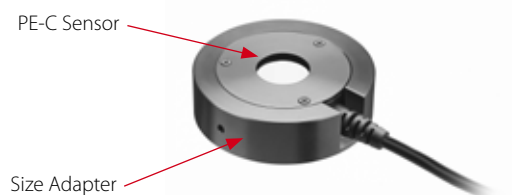

Accessory	Description	Part number
Shock Absorbing Mounting Post	Post with rubber encased thread to isolate sensor from vibration and prevent false triggering at low energy levels.	7Z08268
Damage Threshold Test Plates	Test plates with same absorber coating as the sensor. For testing that laser beam is not above damage threshold (1 such plate is included with sensor package).	Metallic type BF type 7E06031A 7E06031D
Nova PE-C Adapter	The adapter plugs between the Nova D15 socket and the smart plug of the PE-C sensor to allow the Nova to operate with PE-C series sensors. See PE-C spec sheet for details.	7Z08272
PE-C to PE Size Adapter	The newer PE-C series sensors have a $\phi 62\text{mm}$ diameter. The older PE series sensors have a $\phi 85\text{mm}$ diameter. This adapter allows using the PE-C type sensors in jigs and setups that were originally designed for PE sensors.	7Z08273
IR Phosphor Card	Glass slide (75x25mm) with phosphor coating (25x50mm) that visualizes spectral region 810-860nm, 900-1100nm and 1500-1600nm. Stands up to $1\text{KW}/\text{cm}^2$ and $0.5\text{J}/\text{cm}^2$. Self actuating, does not need charging from light source.	7F01235A